

RAILWAY ARCHITECTURE

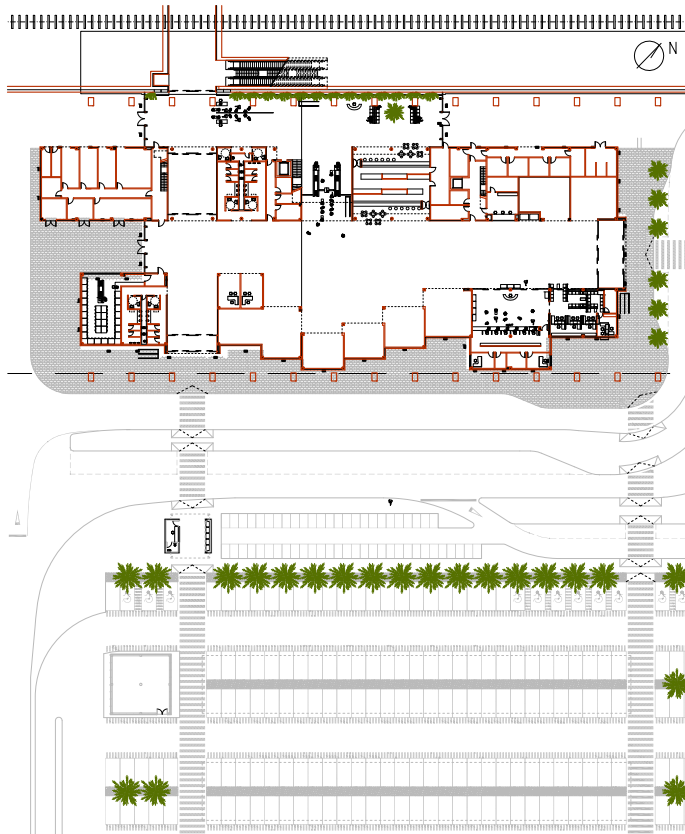

WORKS

Access road - Car park - Bus Park - Motorcycles and bicycles park - Taxi Stop - Kiss & Ride - Urban and intercity bus stop

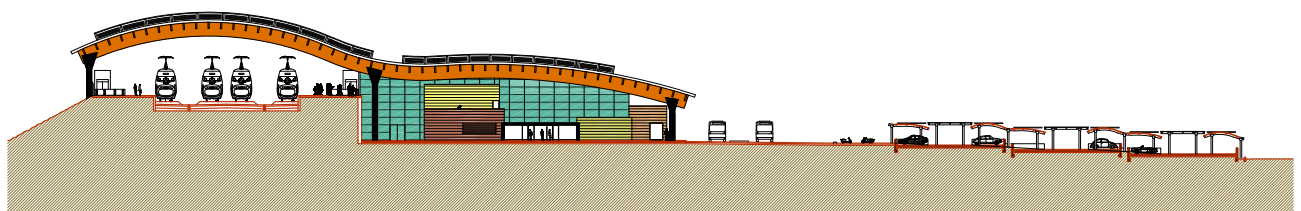

ELCHE HIGH-SPEED STATION, ALICANTE (Project)

OWNERSHIP: ADIF
BUDGET: 21,522,748.18 € / YEAR: 2010

VALENCIAN COMMUNITY

ARCHITECTS: Serdel S.A.P., Gonzalo Velasco and Wenceslao García and G.O.C.