

RAILWAY ARCHITECTURE

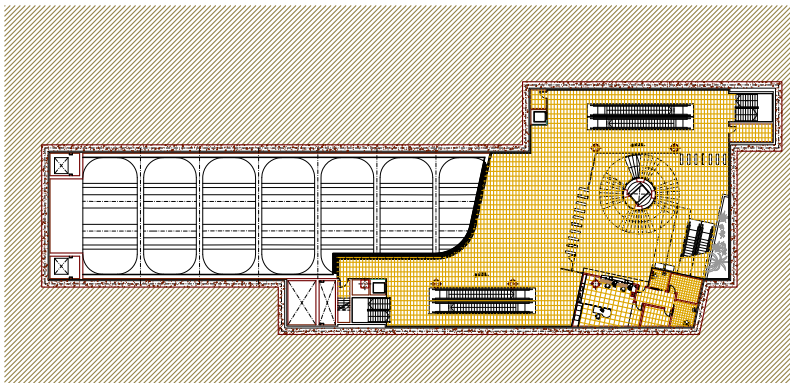

WORKS
Access to the new station – Gardens
Installation of lifts – Installation of
escalators

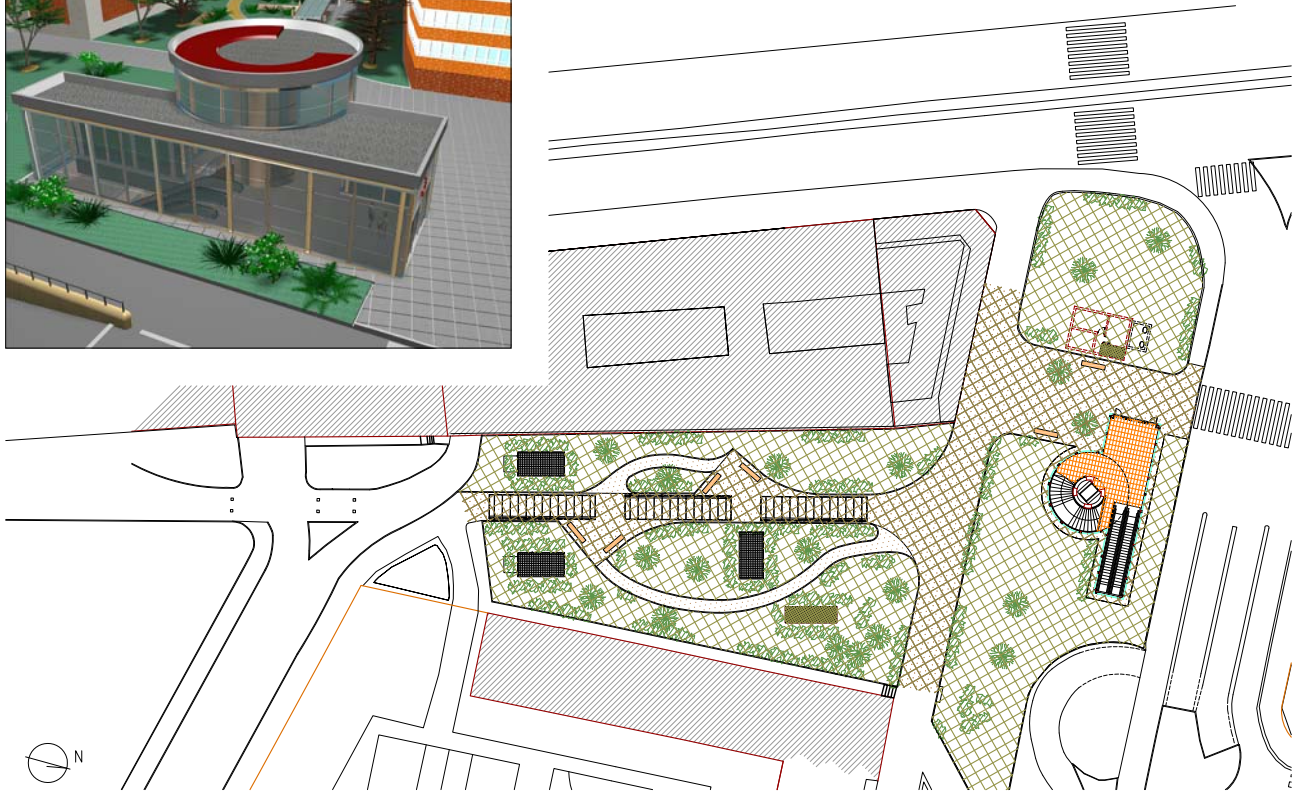

LLAMAQUIQUE STATION, OVIEDO

PRINCIPALITY OF ASTURIAS

OWNERSHIP: ADIF
BUDGET: 1.667.792,68 € / YEAR: 2002

WRITING OF THE PROYECT:
Serdel S.A.P., Gonzalo Velasco and Wenceslao García and INECO-TIFSA